

**SH, 5SH, MSH Discharge Air Patterns**

**SH, 5SH, MSH, DISCHARGE AIR PATTERNS (FACE VIEW)**

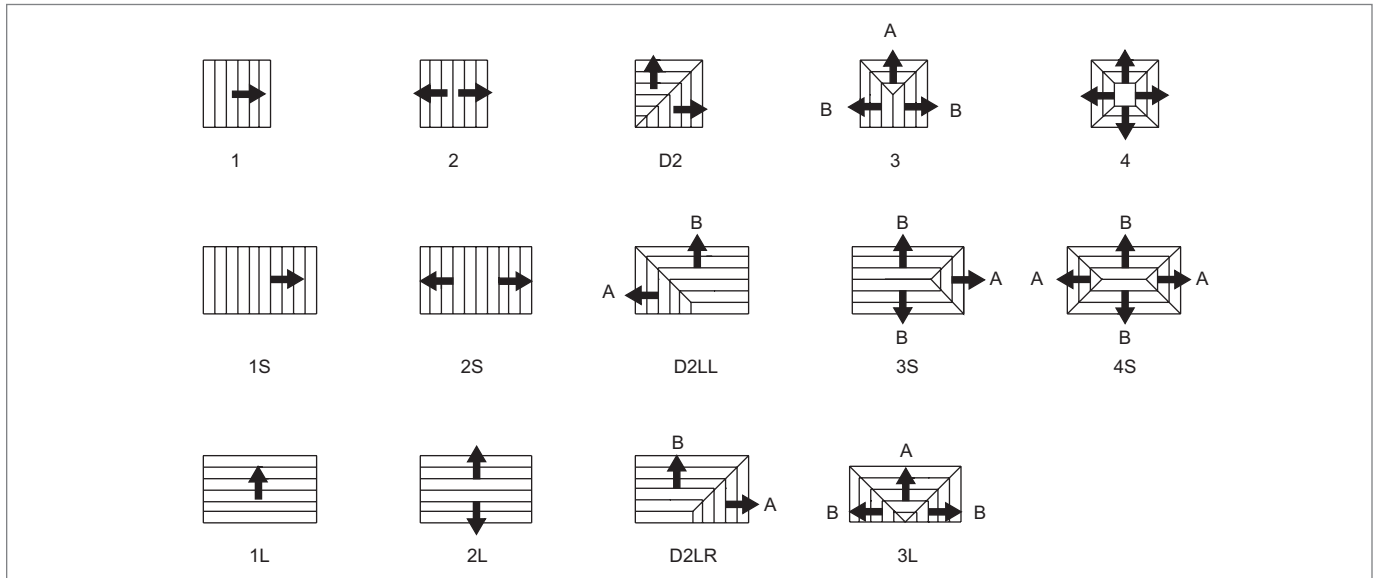

NOTE: 'A' & 'B' notations correspond to performance data.

LOUVERED FACE DIFFUSERS

**SH, 5SH, SHFR, MSH Snap-In Core**

**SNAP-IN CORE INSTRUCTIONS**

The SH series snap-in core is ideal for applications where no screws are required. The core is held in place by two tabs which slide into the outer frame. The other side is secured by a positive lock arrangement. The core is easily removed by releasing the cotter pins (must be removed prior to installation) and removing the core.

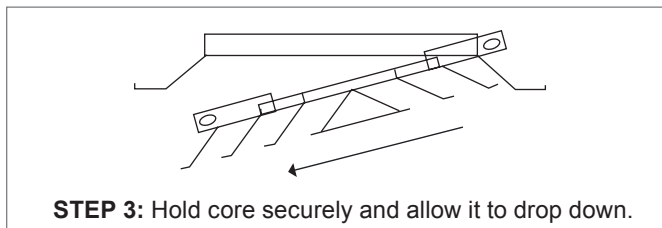
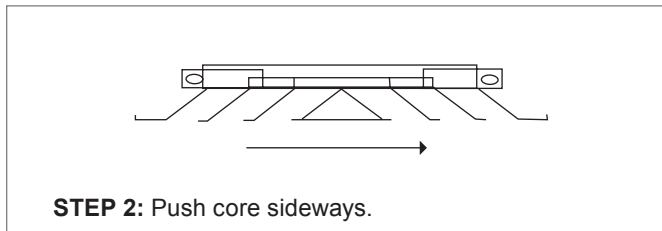
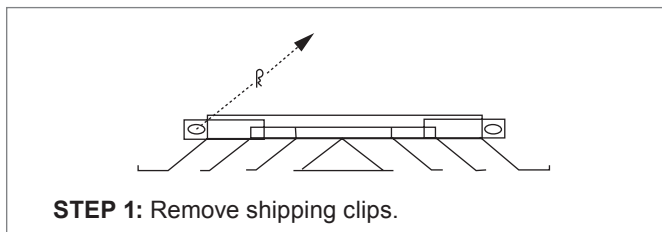

S I - 5 I

**SH, 5SH Reference Chart**

**AIRFLOW VS. NC LEVEL: SH SERIES (NO DAMPER)**

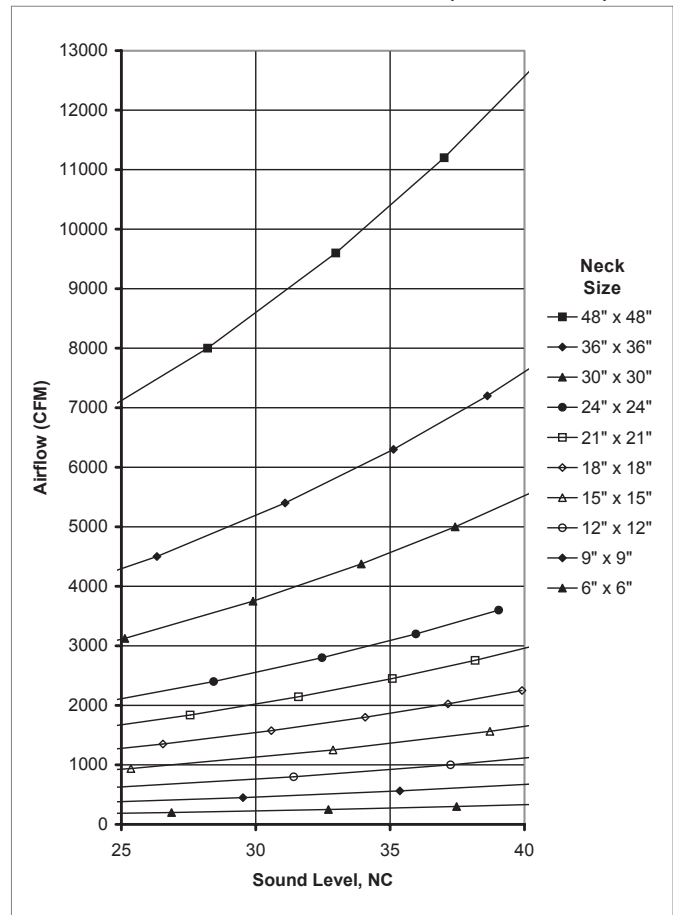

© KRUEGER 2012

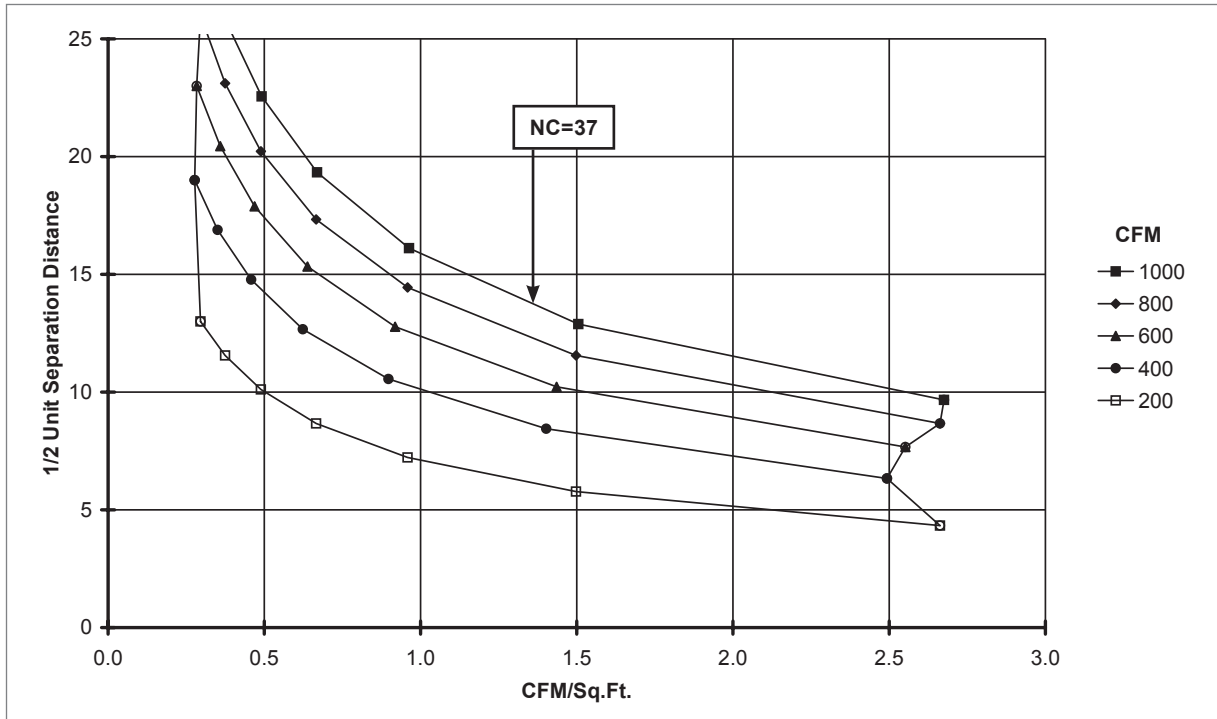
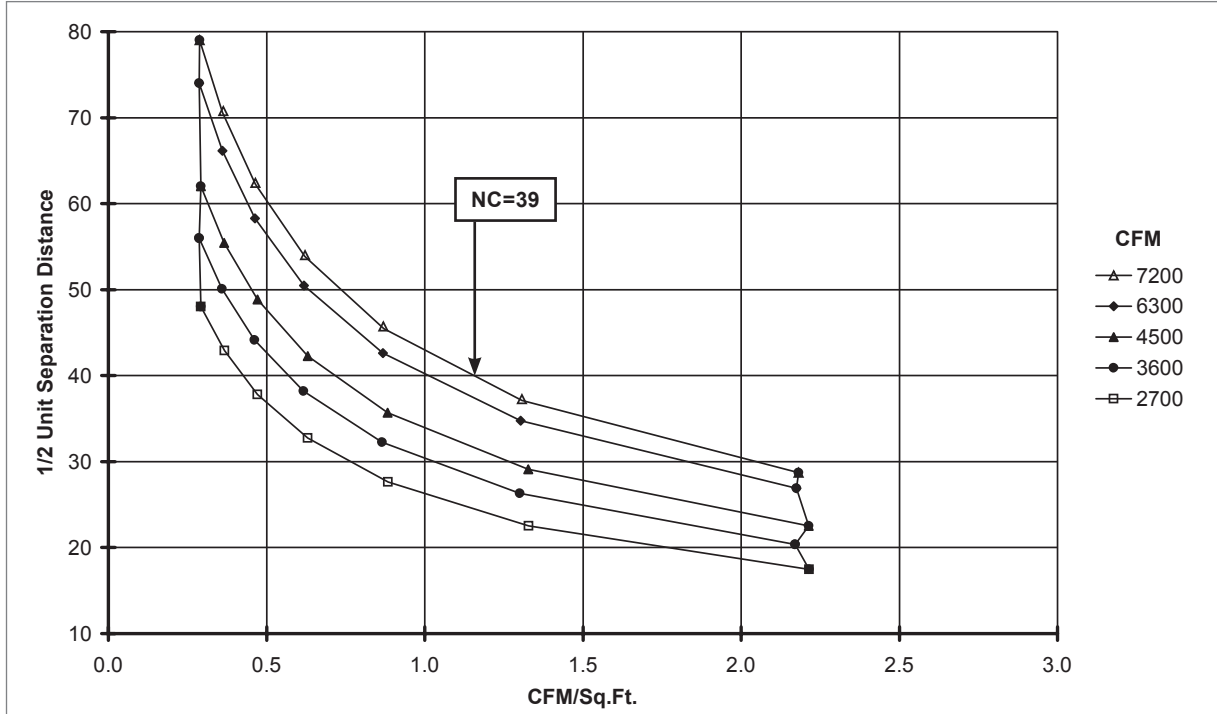
**SH, 5SH, MSH Reference Charts: Horizontal Throw**
**DIFFUSER SPACING FOR 80% ADPI: SH, 5SH, MSH, 12"x12" NECK, 4-WAY (NO DAMPER)**

**DIFFUSER SPACING FOR 80% ADPI: SH, 5SH, 36"x36" NECK, 4-WAY (NO DAMPER)**

NOTES: Charts are at 20 BTUH/ft<sup>2</sup> loads. See the Engineering section of this catalog for instructions on how to read these charts and additional ADPI information.